

STRONG

Digital HD Satellite Receiver SRT 7006



Picture similar

User Manual
Inhaltsverzeichnis
Table des matières
Indice
Índice
Manual do Utilizador
Užívateľská príručka

Používateľská príručka
Instrukcja obsługi
Upute za korištenje
Felhasználói kézikönyv
Kullanıcı Kılavuzu
Руководство пользователя
Посібник користувача



USB
Playback



4000
channels



Digital
audio



Favourite
lists



Energy
saving

DVB-S2

HDMI

Dolby Audio

DisC HD

GotoX

eco
mode

www.strong.tv

Fig. 1



Fig. 2

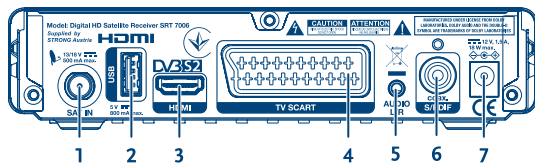

Fig. 3

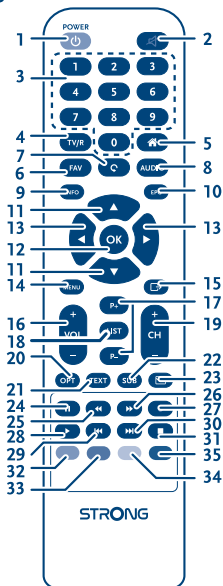

Fig. 4

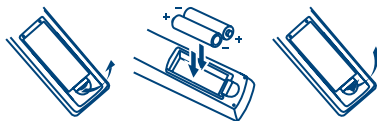

Fig. 5

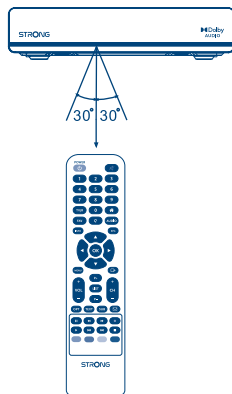

Fig. 6

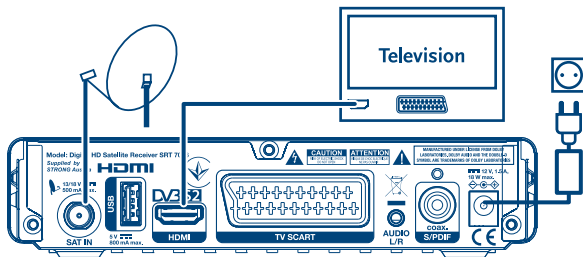

Fig. 7

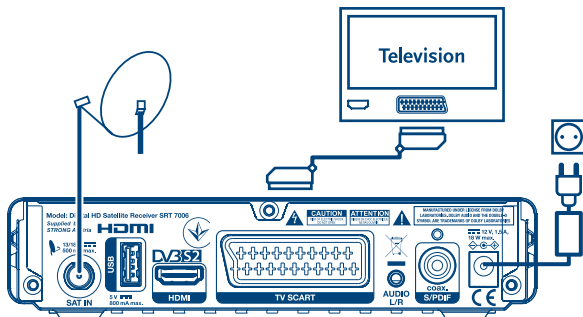
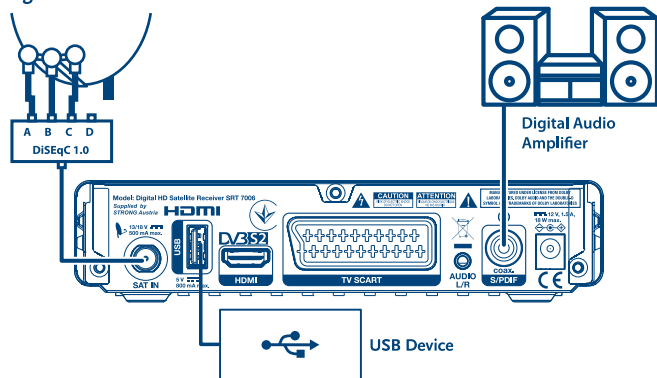

Fig. 8



SERVICE CENTER

AT ✉ support_at@strong.tv
☎ 0820 400 150
(€ 0,12/Min. österr. Festnetz)

BG ✉ support_bg@strong.tv
☎ +359 32 634451

CEE ✉ support_hu@strong.tv
☎ +36 1 445 26 10

DE ✉ support_de@strong.tv
☎ 0180 501 49 91
(€ 0,14/Min. deutsches Festnetz)
(€ 0,42/Min. max. Mobilfunknetze)

DK ✉ support_dk@strong.tv

FR ✉ support_fr@strong.tv

IT ✉ support_it@strong.tv
☎ 199 404 032
Da rete fissa 24,8 cent. al min.
12,5 cent. scatto alla risposta
Da rete mobile max 49 cent. al min.
15,6 cent. scatto alla risposta

NL ✉ support_nl@strong.tv

PL ✉ support_pl@strong.tv
☎ 801 702 017

UA ✉ support_ua@strong.tv
☎ +380 (44) 238 61 50

Supplied by STRONG Austria
Represented by
STRONG Ges.m.b.H.
Franz-Josefs-Kai 1
1010 Vienna
Austria
Email: support_at@strong.tv

15 Dec 2021 10:39



Your receiver is delivered with USB multimedia support. After downloading the software for recording via USB from the website www.strong.tv, the receiver can be upgraded to support the recording and Timeshift function via USB. This user manual describes the full functionality including the recording function and may not be applicable if the software for recording via USB has not yet been installed.

Licenses

THIS PRODUCT IS LICENSED UNDER THE AVC PATENT PORTFOLIO LICENSE FOR THE PERSONAL AND NONCOMMERCIAL USE OF A CONSUMER TO (i) ENCODE VIDEO IN COMPLIANCE WITH THE AVC STANDARD ("AVC VIDEO") AND/OR (ii) DECODE AVC VIDEO THAT WAS ENCODED BY A CONSUMER ENGAGED IN A PERSONAL AND NON-COMMERCIAL ACTIVITY AND/OR WAS OBTAINED FROM A VIDEO PROVIDER LICENSED TO PROVIDE AVC VIDEO. NO LICENSE IS GRANTED OR SHALL BE IMPLIED FOR ANY OTHER USE. ADDITIONAL INFORMATION MAY BE OBTAINED FROM **MPEG LA, L.L.C.** SEE [HTTP://WWW.MPEGLA.COM](http://WWW.MPEGLA.COM)

This product contains one or more programs protected under international and U.S. copyright laws as unpublished works. They are confidential and proprietary to **Dolby Laboratories**. Their reproduction or disclosure, in whole or in part, or the production of derivative works therefrom without the express permission of Dolby Laboratories is prohibited. Copyright 2003-2009 by Dolby Laboratories. All rights reserved.

TABLE OF CONTENTS

1.0 INSTRUCTION	3
1.1 Safety Instructions	3
1.2 Storage	3
1.3 Equipment Set-up	4
1.4 Accessories	4
1.5 Usage of external USB devices	4
2.0 YOUR RECEIVER	5
2.1 PIN code default: 0000	5
2.2 Front and side panel	5
2.3 Rear panel	5
2.4 Remote Control	5
2.5 Installing the batteries	7
2.6 Using the remote control	7
3.0 CONNECTIONS	7
3.1 Basic connection using an HDMI cable	7
3.2 Basic connection using a Scart cable	7
3.3 Connecting multiple fixed LNBS using a DiSeqC switch	8
3.4 Connecting to digital audio amplifier	8
3.5 Connecting a USB storage device	8
4.0 FIRST TIME INSTALLATION	8
4.1 Dish setup	9
5.0 QUICK GUIDE FOR USING YOUR RECEIVER	9
6.0 OPERATION	9
6.1 Changing channels	10
6.2 Info Banner	10
6.3 Selection of audio language	10
6.4 Teletext	11
6.5 Subtitles	11
6.6 Changing the aspect ratio	11
6.7 Changing the resolution	11
6.8 EPG (Electronic Programme Guide)	11
6.9 Favourite channels	11
7.0 MAIN MENU	12
7.1 Programme	12
7.2 Picture	14
7.3 Channel Search	15
7.4 Time and date settings	19
7.5 Option	20
7.6 System Settings	20
7.7 USB	21
8.0 TROUBLESHOOTING	25
9.0 SPECIFICATIONS	27

1.0 INSTRUCTION

1.1 Safety Instructions

DO NOT INSTALL YOUR RECEIVER:

- In a closed or poorly ventilated cabinet; directly on top of or under any other equipment; on a surface which might obstruct the ventilation slots.

DO NOT EXPOSE THE RECEIVER OR ITS ACCESSORIES:

- To direct sunlight or any other equipment that generates heat; to rain or intense moisture; to intense vibration and to any shock which may cause permanent damage to your receiver or to any magnetic objects, such as loudspeakers, transformers, etc.
- Do not use a damaged power cord. It may cause a fire or an electric shock. Do not touch a power cord with wet hands. It may cause an electric shock.
- When the receiver is not used for a long period of time, you should unplug the power cord from the wall socket.
- Do not use alcohol or ammonia based liquids to clean the receiver. If you wish, you may clean your receiver with a soft lint-free cloth slightly made damp with a mild soap solution, and only after disconnecting from the mains voltage supply. Make sure no foreign objects fall through the ventilation slots because this could cause fire or an electric shock.
- Do not place any objects on top of the receiver because this might prevent proper cooling of the components inside.

Safety Precautions

- Never try to open the receiver. It is dangerous to touch the inside of the receiver due to high voltages and possible electrical hazards. Opening the receiver will void the warranty of the product. Refer all maintenance or servicing to suitably qualified personnel.
- When you are connecting cables, be sure that the receiver is disconnected from the mains supply voltage. Wait a few seconds after switching off the receiver before you move the receiver or disconnect any equipment.
- It is a necessity that you only use an approved extension and compatible wiring that is suitable for the electrical power consumption of the installed equipment. Please ensure that the electrical power supply corresponds with the voltage on the electrical identification plate at the back of the receiver.

If the receiver does not operate normally even after strictly following the instructions in this user manual, it is recommended to consult your dealer.

1.2 Storage

Your receiver and its accessories are stored and delivered in a packaging designed to protect against mechanical shocks and moisture. When unpacking it, make sure that all the parts are included and keep the packaging away from children. When transporting the receiver from one place to another or if you are returning it under warranty conditions, make sure to repack the receiver in its original

packaging with its accessories. Failing to comply with such packaging procedures could damage the product and void your warranty.

1.3 Equipment Set-up

We recommend you consult a professional installer to set up your equipment. Otherwise, please follow the instructions below:

- Refer to the user manual of your TV and your antenna.
- Make sure that the SCART/HDMI cable and outdoor components are in a good condition and the SCART/HDMI connections are well shielded and from good quality.

This manual provides complete instructions for installing and using this receiver. The symbols serve as follows.

WARNING

Indicates warning information.

NOTE

Indicates any other additional important or helpful information.

MENU

Represents a button on the remote control or the receiver. (**Bold characters**)

Move to

Represents a menu item within a window. (*Italic characters*)

1.4 Accessories

- 1x installation instructions
- 1x remote control
- 2x batteries (AAA type)

NOTE:

The batteries should not be recharged, disassembled, electrically short-circuited or be mixed or used with other types of batteries. If rechargeable accumulators instead of batteries are going to be used, we recommend using (e.g. NiMH) types with low self-discharge to ensure long time operation of remote control.

1.5 Usage of external USB devices

- It is recommended to use USB 2.0 storage devices. If your device is not compatible to USB 2.0 specifications, multimedia, recording and Timeshift functions of the receiver might not work properly.*
- If you are going to use an external USB HDD (Hard Disk Drive), please consider that the power specifications may exceed the supported output of your receiver (5 V/800 mA). If so, please connect your USB HDD to an according external power adapter.
- STRONG cannot guarantee compatibility with all types of USB storage devices.
- It is advised not to store important information on USB storage devices used with the receiver. Always make backups of data on your USB storage device before using it with this receiver. STRONG will not take responsibility for any loss of information or circumstances caused by loss of information.
- STRONG cannot guarantee the playback of all files although extensions are listed, as it depends on file size, codec, bit rate and resolution.
- Please ensure that either the USB device is already formatted to FAT/FAT32, or format the USB device via your receiver, refer to chapter 7.7 **USB** for details.

*This user manual describes the full functionality including the recording function and may not be applicable if the software for recording via USB has not yet been installed.

2.0 YOUR RECEIVER

2.1 PIN code default: 0000

2.2 Front and side panel

Fig. 1

- Standby indicator:** Shows power state of the receiver
Green LED - receiver is turned on
Red LED - receiver is in standby mode
- Remote control sensor:**
Receives the signal from the remote control

2.3 Rear panel

Fig. 2

- SAT IN** To connect to the LNB of your satellite dish for reception of satellite broadcast signal
- USB** For connection of USB device for Multimedia use
- HDMI** To connect to the HDMI input of your TV using a good quality HDMI cable
- TV SCART** To connect to TV using a SCART cable
- Audio L/R** To connect to an analogue amplifier for stereo audio
- S/PDIF coaxial** To connect to a digital or home cinema audio amplifier
- Power connector** The receiver requires a wall adapter, mains voltage input 100~240V AC 50~60Hz 12V, 1.5A DC output. Please check the local power conditions before connecting the receiver to the mains supply

2.4 Remote Control

Fig. 3

- ⏻** Turns the receiver ON/Standby
- 🔊** To turn the sound on or off
- 0-9** Channel number and numeric value input
- TV/R** Toggles between TV and radio mode
- 🏠** No function
- FAV** To access your favourite channels. Toggles between available favourite groups
- ↻** To switch between the last viewed channels
- AUDIO** Displays the audio selection menu with selections for available languages and audio modes
- INFO** Press once to display channel number/name and current/coming information. Press twice to display detailed event information. Press again to get back to viewing mode
- EPG** Viewing mode: Displays the EPG (Electronic Programme Guide)

- | | |
|------------|---|
| 11. ▲/▼ | Switches to the next/previous channel in viewing mode, switches to the next/previous page in channel list or moving the highlight up/down in the menu |
| 12. OK | Viewing mode: Displays the channel list. Menu: activation of the highlighted item |
| 13. ◀▶ | Decreasing/increasing the volume level in viewing mode/ navigating through the menus/changing values of settings in a menu |
| 14. MENU | To open the main menu in viewing mode or to go one step back in the menu |
| 15. ↵ | Cancellation of current process/exit from main menu to viewing mode |
| 16. VOL+/- | Increases/decreases the volume level in TV mode |
| 17. P+/P- | Jumps 10 places up or down in channel list or any other list. |
| 18. LIST | Displays the channel list. |
| 19. CH+/- | Channel up/down |
| 20. OPT | No function. |
| 21. TEXT | To open Teletext if available on the current channel. |
| 22. SUB | To select subtitles language out of available ones on the current channel |
| 23. ☑ | No function |
| 24. II | Hold play during playback/starting Timeshift mode* |
| 25. ◀◀ | Searches backwards during playback/Timeshift*. Each pressing increases the speed (x2 – x32) |
| 26. ▶▶ | Searches forwards during playback/Timeshift*. Each pressing increases the speed (x2 – x32) |
| 27. ● | Starts recording of the currently watched programme*. Toggles between lists in menu. |
| 28. ▶ | Starts/resumes the playback/Timeshift*. Shortcut to recordings list in viewing mode. |
| 29. ◀◀ | Jumps to the previous file during playback. |
| 30. ▶▶ | Jumps to the next file during playback. |
| 31. ■ | Stops playback of multimedia files and Timeshift*. |
| 32. RED | Flexible functions in OSD menu and Teletext. |
| 33. GREEN | Flexible functions in OSD menu and Teletext. Changes the picture resolution in viewing mode. |
| 34. YELLOW | Flexible functions in OSD menu and Teletext. Changes the picture Aspect Ratio in viewing mode. |
| 35. BLUE | In viewing mode: displays the schedule menu for easy setup timers; Flexible functions in OSD menu and Teletext. |

*This user manual describes the full functionality including the recording function and may not be applicable if the software for recording via USB has not yet been installed.

2.5 Installing the batteries

Fig. 4

Remove the battery cover from the remote control and put 2x AAA size batteries inside the compartment.

The diagram inside the battery compartment shows the correct way to install the batteries.

1. Open the cover
2. Install batteries
3. Close the cover

NOTE: The batteries should not be recharged, disassembled, electrically short-circuited, be mixed or used with other types of batteries.

2.6 Using the remote control

Fig. 5

To use the remote control, point it towards the front of the digital receiver. The remote control has a range of up to 7 metres from the receiver, if properly aligned towards the IR eye on the front panel. The remote control will not operate if its path is blocked.

Note: Sunlight or very bright light might decrease the sensitivity of the remote control.

3.0 CONNECTIONS

3.1 Basic connection using an HDMI cable

Fig. 6

- a) Connect the LNB of your satellite antenna to the SAT IN connector of your receiver using a good quality coax cable and suitable 'F-connector' plugs.
- b) Connect one end of a good quality HDMI cable to the HDMI output on your receiver and the other end to the HDMI input of your TV.
- c) Plug the power adapter to a suitable wall outlet.

3.2 Basic connection using a Scart cable

Fig. 7

- a) Connect the LNB of your satellite antenna to the SAT IN connector of your receiver using a good quality coax cable and suitable 'F-connector' plugs.
- b) Connect one end of a good quality Scart cable to the TV SCART connector on your receiver and the other end to the SCART input of your TV.
- c) Plug the power adapter to a suitable wall outlet.

3.3 Connecting multiple fixed LNBs using a DiSEqC switch

Fig. 8

- Connect the LNBs of your fixed antenna to the inputs of a DiSEqC switch
- Connect the output or “to receiver” connector of the DiSEqC switch to the SAT IN connector on your receiver.
- Refer to section 3.1 or 3.2 for TV and mains connections.

3.4 Connecting to digital audio amplifier

Fig. 8

Connect one end of a good quality coaxial audio cable to the S/PDIF output of your receiver and the other end to the coaxial audio input of your home theatre, amplifier or any other device supporting digital audio.

3.5 Connecting a USB storage device

Fig. 8

NOTE It is recommended to use USB 2.0 or higher storage devices for recording and play back of TV programmes or HD movies.*

NOTE Timeshift/recording and playback only works properly when a fast USB storage device such as a USB2.0 HDD is connected to the receiver. Timeshift/recording and playback of HD content requires a sufficient read/write speed of the used USB storage device.*

*This user manual describes the full functionality including the recording function and may not be applicable if the software for recording via USB has not yet been installed.

4.0 FIRST TIME INSTALLATION

After all connections have been made properly, switch on your TV and make sure the receiver is connected to the main power. If you are using the receiver for the first time or restored to factory default, the *Installation guide* menu will appear on your TV screen. Use ◀▶ to select the *OSD Language* of your preference. Set the other options as are appropriate for your situation. HDMI output is always available. TV format with HDMI connection is 16:9 Wide screen.

NOTE If Germany or Italy is selected as country, a pre-installed channel list is available. German channels from ASTRA 19.2E will be installed. Italian channels from Hotbird 13E will be installed.

You can continue to *Channel search* and install further channels as described below or directly go to viewing mode by pressing **OK** to start enjoying the pre-installed channels immediately.

4.1 Dish setup

4.1.1 Satellite Selection

Use ▲/▼ to highlight the satellite your dish is aimed at. When using a multi feed antenna with more than 1 LNB, select the satellites your antenna is adjusted for by pressing **OK** and set the appropriate LNBs in the right-hand screen by pressing ► at the DiSEqC 1.0 or, if applicable, DiSEqC 1.1 option. The scan process will then search on all selected satellites. If using motorized antennas or SatCR, please refer to chapter 7.

4.1.2 Signal Adjust

The signal Strength and Quality bar on the bottom of the screen allows you to fine tune the alignment of your antenna for optimum reception. Adjust your antenna for maximum possible signal strength and quality. When the signal cannot be improved anymore, fix the dish on this position and press the **BLUE** button for *Scan* options and scan.

4.1.3 Scan Mode

Use ▲/▼ to highlight the options of choice and press **BLUE** to start the *scan*. It is recommended to use the default settings.

4.1.4 Scan

Your receiver will now perform an automatic channel search. When the process has been completed, all found channels will be stored and the receiver will switch to the first found channel. You are now ready to enjoy your new receiver.

NOTE

If no channels were found during the automatic channel scan, the receiver will return to *Installation guide* menu. Please select your language again and refer to chapter 7.3 for further instructions.

5.0 QUICK GUIDE FOR USING YOUR RECEIVER

We at STRONG understand that you can't wait to enjoy your new HD receiver. The following quick guide will make you familiar with the basic operation of this device. We do, however, advice you to read the full manual to get the best performance from your STRONG HD receiver.

To turn your receiver ON or to Standby, press **⏻** on the remote control.

Choose channels with ▲/▼. Alternatively, you can also enter the channel number with the 0~9 buttons on the remote control or press **OK** in viewing mode to display the channel list.

The volume can be adjusted with ◀▶.

6.0 OPERATION

In viewing mode, several features are available to make watching TV a true pleasure. This paragraph describes these features. Please also read chapter 7 to get familiar with the menu of your new receiver.

6.1 Changing channels

There are different ways to change channels with your new receiver.

- Via direct access
- Via the channel list
- Via the ▲/▼ buttons
- Via the ⌂ button

6.1.1 Direct access

To gain direct access to a certain channel, simply enter its number with the 0~9 keys on the remote control. Channel numbers can be up to four digits long. Entering a number with less than four digits is possible. Just wait a few seconds and your receiver will switch to the selected channel.

6.1.2 Channel list

Press **OK** in viewing mode to display the channel list. Use ▲/▼ to highlight your channel of choice and press **OK** once to select the highlighted channel. The channel list is equipped with a *Find* function to make it easier to find channels. In the channel list, press **RED** and an alphabet banner will be displayed. Use ▲/▼ ◀▶ to select the first letter (or letters) of your channel of choice and select **OK** to confirm or just press ⌂. All channels beginning with the chosen letter(s) will now be displayed. Select the channel in the filtered list.

The following buttons are available in the channel list and in viewing mode:

- RED:** Opens an alphabet banner to quickly find a channel
- TV/R:** Toggles between TV and radio channels
- Opens the *Satellite List* for satellite selection

6.1.3 Using the ▲/▼ buttons

- ▲ will switch to a higher channel.
- ▼ will switch to a lower channel.

6.1.4 Using the ⌂ button

Use the ⌂ button for switching between the last 8 viewed channels. Please refer to section 7.6 for more details.

6.2 Info Banner

At any time during viewing mode you can press the **INFO** button to get information about the current channel as well as the current and following programme*. Press **INFO** twice to view detailed info of current and following programmes and technical details about the current channel. Press **INFO** again or ⌂ to close the information.

You can change the on-screen duration of the info banner in the *System* menu. Please refer to section 7.5 for more details.

*Programme information is displayed when available. Availability depends on broadcast.

6.3 Selection of audio language

Some channels support a choice of different audio formats and/or languages. To select another audio stream, press **AUDIO** in viewing mode. A list with available audio streams will now be displayed. Use

▲/▼ to select a stream and confirm with **OK**. With the ◀▶ buttons you can choose between *Mono left*, *Mono right* or *Stereo audio (left/right)*.

6.4 Teletext

Your receiver includes a fully featured Teletext. To access Teletext, press the **TEXT** button in viewing mode and use the 0~9 or ▲/▼ buttons to select the number of the page you wish to see. Subpages (if loaded and available) can be selected with the ◀▶ buttons. The coloured buttons of the remote control allow you to jump to selected pages directly, as indicated on the bottom of the teletext screen. Press **TEXT** again or ⏪ to go back to viewing mode.

6.5 Subtitles

Some programmes support a choice of different DVB subtitle languages. Press the **SUB** button in viewing mode to display a list of available subtitle languages. Use ▲/▼ to select a subtitle language and confirm with **OK**.

6.6 Changing the aspect ratio

To change the *Aspect Ratio* while watching TV, press the **YELLOW** button in viewing mode. Each press will switch to the next format. Please refer to section 7.2 for more details.

6.7 Changing the resolution

To change the *Resolution* while watching TV, press the **GREEN** button in viewing mode. Each press will switch to the next format. A confirmation screen will pop-up. If not confirmed, the resolution will fall-back to previous state within 1 0seconds. Please refer to section 7.2 for more details.

6.8 EPG (Electronic Programme Guide)

The Electronic Programme Guide is a very useful function that allows you to watch programme schedules and information on screen. Press the **EPG** button to activate this guide (you can also enter EPG via the menu too). Use ◀▶ to select a channel. In the programme list, use ▲/▼ to select or scroll through programmes to display programme information for the next/previous days. Press the **BLUE** or **YELLOW** buttons if there is more than one page of information to scroll. Press **OK** to book the selected programme for a timer. View the book list by pressing the **INFO** button.

NOTE

Availability of EPG data depends on broadcast.

Booking a programme from EPG

Select a programme as described above. Press **OK** when you have selected a programme. This will lead you to the Timer (*Schedule*) menu. All details are already filled in for you. Save the timer with **OK**. To display the list of booked events just press the **BLUE** button while being in viewing mode or **INFO** while being in the EPG. Please refer to section 7.4.1 for more details.

6.9 Favourite channels

Use the **FAV** button to access your favourite channels and use ◀▶ to toggle between available favourite groups. Please refer to section 7.1.1 for details on how to create favourite lists.

7.0 MAIN MENU

7.1 Programme

Press **MENU** and select *Programme* by using the ◀▶ buttons. Press **OK** or the ▼ button to enter the *Programme* submenus. Press **OK** or the ▶ button to edit programme settings. Press ⏪ to exit the menu.

7.1.1 Programme Edit

To edit your programme preferences (move, skip, lock, delete, favourite or rename), please go to the *Programme Edit* menu. This menu requires a password upon access. Enter your password or use the default password '0000' if you did not change it. Use ▲/▼ ◀▶ to highlight a channel, **TV/R** to toggle between TV and radio channel lists and ● to select a satellite (if more than one available).

Set favourite programme

Your receiver allows you to store channels in up to 8 favourite lists. Due to the large number of channels available on satellite nowadays, this can be a very useful function.

1. Highlight the preferred programme, then press the **FAV** button. A *Favourite Type* window will pop up on screen. The following groups are available: *News, Sport, Music and Movie1, Movie2, Movie3, Movie4*. Please select one (or more) of them. A star shaped symbol will appear and the programme is marked as a favourite. Press ⏪ to return to the channel list for further selection.
2. Repeat the previous step to select more favourite programmes.
3. To confirm and exit the menu, press ⏪.

Disable favourite TV or radio programme

Repeat step 1 described above and select *Disable* in the *Favourite Type* window.

View favourite programme

1. In normal viewing mode (no menu mode) press the **FAV** button to display a list of favourite programmes. In the favourite list, use ◀▶ to switch between available favourite lists.
2. Select your favourite programme by ▲/▼ and press **OK** to switch to it.
3. Now in viewing mode you can select channels from the chosen favourite group only by pressing ▲/▼. If you want to change to the main channel list, press **OK** in viewing mode and then press ● and select *All TV list*.

Delete a TV or radio programme

1. Select the programme you want to delete and press the **BLUE** button. A message will appear. Press **OK** to delete the programme or ⏪ to cancel.
2. Repeat the previous step to delete more programmes.

Skip TV or radio programme

1. Select the programme you want to skip and press the **GREEN** button.

2. The programme will be marked to skip. The receiver will skip this programme while zapping between programmes in normal viewing mode (in channel list mode the skipped channels remain selectable).
3. Repeat the previous step to skip more programmes.
4. To confirm and exit the menu, press **↵**.

Disable a skipped TV or radio programme

Press the **GREEN** button on the programme marked with the skip symbol.

Move a TV or radio programme

1. Select the programme you want to move, then press the **RED** button. A move symbol will appear.
2. Press **▲/▼ ◀▶** to move the programme.
3. Press **OK** or **RED** again to confirm the new position.
4. Repeat the above steps to move more channels.

Locking programmes

You can lock selected programmes for restricted view.

1. Select the programme you want to lock, then press the **YELLOW** button. The programme is now marked as locked.
2. Repeat the previous step to select more programmes
3. To confirm and exit the menu, press **↵**.

To view the locked programme, you need to enter either the default password '0000' or your last set password. We recommend changing of the default password to one of your preference. Please refer to chapter 7.6 **System** for more details.

Disable a locked TV or radio programme

Press the **YELLOW** button on the programme marked with the lock symbol.

Rename a TV or radio programme

1. Select the programme you want to rename and press **C**. A key table appears.
2. In the key table select a character by using the navigation buttons. Press **OK** to enter the character. When you have entered the new name, navigate to the "OK" button on screen and press **OK** on the remote control to confirm the new name.
3. To store the changes and exit the menu, press **↵**.

7.1.2 EPG (Electronic Programme Guide)

Please refer to section 6.8 above.

7.1.3 Sort

Here you can sort your channels in the following orders:

<i>Default</i>	Sort the channels in the original order
<i>By Encrypt</i>	Sort the channels from free to scrambled
<i>By Frequency</i>	Sort the channels in frequency order (Low-High)
<i>By Service Name</i>	Sort the channels in alphabetical order (A-Z)

Recall List

Enable or disable the *Recall list* function, which supports multi-recall-channel switching. If the status is set *ON* then a list of previously selected channels will be displayed for new selection by pressing the **Q** button. If the status is set *OFF* then the receiver just will switch to the previously selected channel by pressing the **Q** button.

7.2 Picture

Press **MENU**, then select *Picture*. The menu provides options to adjust the video settings. Press **▲/▼** to select an option and **◀▶** to adjust the setting. Press **⏏** to exit the menu.

Aspect Ratio

You can set the display format to available settings like *16:9 Widescreen*, *16:9 Pillarbox*, *4:3 Letterbox*, *4:3 Pan&Scan*.

<i>16:9 Widescreen</i>	For 16:9 TV screens. All programmes will fill the full screen. Content formatted in 4:3 will be stretched.
<i>16:9 Pillarbox</i>	For 16:9 TV screens. The unit will display all content in its original aspect ratio. Programmes formatted in 4:3 will be presented with black bars on the left and right.
<i>4:3 Letterbox</i>	For 4:3 TV screens. The unit will display all content in its original aspect ratio. Programmes formatted in 16:9 will be presented with black bars on the top and bottom.
<i>4:3 Pan&Scan</i>	For 4:3 TV screens. 16:9 content will have the extreme left and right portions cut off and presented full screen.

TIP

You can change the video output format directly from viewing mode by pressing the **YELLOW** button on the remote control.

Resolution

If the video does not appear correctly, change the setting. These settings match the most common settings for HDMI.

1. **480i:** for NTSC system TV.
2. **480p:** for NTSC system TV.
3. **576i:** for PAL system TV.
4. **576p:** for PAL system TV.
5. **720p:** for NTSC or PAL system TV.
6. **1080i:** for NTSC or PAL system TV.
7. **1080p:** for NTSC or PAL system TV.

TIP

You can change the video resolution directly from viewing mode by pressing the **GREEN** button on the remote control.

TV Format

Set the standard corresponding to your TV set. Available options are: *PAL* and *NTSC*.

Video Output

This setting is only relevant when the receiver is connected to the TV set via Scart. Select *RGB* for the best picture quality or *CVBS* if your TV doesn't support *RGB*.

7.3 Channel Search

To access the menu press **MENU** and select *Channel Search*. It contains two options: *Dish setup* and *DB (Data Base) Management*. Select an option and press **OK** to enter it. Press **EXIT** to exit the menu.

7.3.1 Installation

7.3.1.1 Dish setup

Use **▲/▼** to highlight the satellite your dish is aimed at. Its antenna settings will be shown at the right side. You can enter the right side with the **◀▶** buttons and return to the satellite list with **EXIT**.

7.3.1.2 Configure the antenna settings for the selected satellite

<i>LNB Type:</i>	Press ◀▶ or OK to show the list of LNB Types. The Universal LNB (09750/10600 MHz) is supported – the most used on the market. SatCR A and SatCR B are used for SatCR systems. If only 1 SatCR LNB is connected, use SatCR A. SatCR systems are mainly installed by professional experts. An optional satellite splitter is required for multi-users.
<i>LNB Power:</i>	Use ◀▶ to set the LNB power. 13/18V is the setting for a Universal LNB.
<i>22KHz:</i>	Use ◀▶ to switch the 22KHz oscillator signal on or off. <i>Auto</i> is the setting for a Universal LNB.
<i>DiSeqC1.0:</i>	To select the correct port from up to 4 (if available) for the corresponding LNB.
<i>DiSeqC1.1:</i>	To select the correct port from up to 16 (if available) for the corresponding LNB.
<i>Motor:</i>	If using a motor driven dish, press ◀▶ to choose between <i>DiSeqC1.2</i> and <i>DiSeqC1.3</i> depending on the motor type you use.

DiSeqC 1.2

DiSeqC 1.2 is a protocol for motor-driven dishes, the dish/motor-combination itself needs to be aligned due South (North for Southern hemisphere) at its reference position at 0°. It is possible to manually search and store every satellite individually.

Refer to the manual of your motor-drive for more detailed information. Modern motor drives have usually also the capability of the enhanced DiSeqC 1.3 protocol, which would be preferred, since it can find satellite positions automatically, relative to a geographical location.

Move the motor to the right position for locking the signal like explained below. Press **OK** to enter the submenu.

Move Continue: Press **◀▶** for moving *West/East*. Press the opposite **◀▶** to stop moving.

Move Step(1): Press **◀▶** for moving *West/East* in 0.3° step.

Store Position: To store the current motor position for selected satellite. If your dish is physically obstructed to the East or West (example by a wall), you can limit its moving range by pressing the **RED** button to *Set Limit*.

Use:

Move Continue:
Move Step(1):

Press ◀▶ for moving *West/East*. Press the opposite ▶◀ to stop moving.
Press ◀▶ for moving *West/East* in 0.3° step. Check if you are still well clear of the obstruction. Then select *Set East* or *West Limit*, according to the direction, and press OK twice to store. Repeat if there is also an obstruction to the opposite direction. Moving outside the range of your dish will thus be prevented. Both limits can be disabled with *Disable Limit*.

DiSEqC 1.3

DiSEqC 1.3 (also known as GotoX) is an automated system for finding satellites with a motor driven dish. It is an enhancement of the DiSEqC 1.2 protocol, where it was still needed to manually search and store every satellite individually. With DiSEqC 1.3 every satellite position is automatically calculated for a defined geographical location on earth. Only this location is needed to be entered and stored in to the box, in conjunction with a DiSEqC 1.3 capable motor drive, all (pre-installed) satellites can easily be found. The dish/motor-combination itself needs to be aligned due South (North for Southern hemisphere) at its reference position at 0°. Refer to the manual of your motor-drive for more detailed information.

Select *DiSEqC 1.3* with the ◀▶ buttons. Press the **GREEN** button to setup your location coordinates. A pop-up window will appear, in which the following settings can be made:

Location:

Longitude Direction: Choose *East* or *West*.

Longitude Angle: Use the 0 ~ 9 buttons to enter the coordinate.

Latitude Direction: Choose *North* or *South*.

Latitude Angle: Use the 0 ~ 9 buttons to enter the coordinate.

When all settings have been made, press ⏏ to save the data and leave the window.

Note:

The location setting only needs to be entered once, and is valid for all satellites. If needed, the motor can physically be brought to its 0° reference position, to align the dish South (or North for for Southern hemisphere) first.

Press **OK** to enter the *GotoX* menu.

Select *Goto Reference* to move the dish to the reference position of 0°. Press OK twice to move.

If your dish is physically obstructed to the East or West (example by a wall), you can limit its moving range by pressing the **RED** button to *Set Limit* to prevent it hitting the obstruction.

Use:

Move Continue:
Move Step(1):

Press ◀▶ for moving *West/East*. Press the opposite ▶◀ to stop moving.
Press ◀▶ for moving *West/East* in 0.3° step. Check if you are still well clear of the obstruction. Then select *Set East* or *West Limit*, according to the direction, and press **OK** twice to store. Repeat if there is also an obstruction to the opposite direction. When accidentally selecting satellites from the list which are out of range by your dish, it will not run in to the obstruction. Both limits can be disabled with *Disable Limit*.

7.3.1.3 Channel Scan

Automatic Scan

- Satellite Scan:** Select a satellite in the left window to be scanned. More than one can be selected. Press **BLUE** for *Scan*. A window with scan settings will be displayed. Use ◀▶ to select *Default*, *Blind Scan* or *NetWork*.
- Scan Mode:** All stored transponders in the memory will be scanned.
- Default:** Slow scan in 2 MHz steps. The receiver will first scan the whole frequency band to find the transponders it can lock on. After gathering all transponders, it scans the transponders one by one to get all available programmes.
- Blind Scan:** Network search will be performed – when network information is broadcast, new transponders will be found and stored.
- NetWork:** Press ◀▶ to select *All Channels* (scrambled and free) or *FTA Channels* (free to air);
- Scan type:** Press ◀▶ to select *ALL*, *DTV* or *Radio*.
- Service Type:** After configuring, press **OK** or **BLUE** again to start scanning with the selected settings. Your receiver will now perform an automatic channel search with the scanning progress shown on screen. During the channel search you can skip transponders by pressing the **MENU** button, or quit the scan process with ⏏. When the process has been completed, all found channels will be stored and the receiver will switch to the first found channel.
- Multi-Satellites Scan:** When using a multi feed antenna with more than 1 LNB, select the satellites your antenna is adjusted to with the **OK** button. The selected satellites will be marked by the ✓ symbol. Set the appropriate LNB inputs in the DiSEqC point and press **BLUE** for *Scan*. A window with scanning settings will be displayed. After configuring the settings like explained in Single Satellite Scan above, press **OK** or **BLUE** again to start Multi-Scan on all selected satellites.

7.3.1.4 Scanning by transponder (Manual Scan)

Press ● for displaying the transponder list of the highlighted satellite. By pressing Press ● again you can switch back to the satellites list.

Single Transponder Scan:

Use the ▲/▼ buttons to highlight the transponder you want to scan and press **OK**. Press **BLUE** for *Scan*. A window with scanning settings will be displayed. After configuring the settings (explained in 7.3.1.3 above), press **OK** or **BLUE** again to start the scanning of the highlighted transponder. When the scan process has been completed, all found channels will be stored and the receiver will switch to the first found channel.

Multi-Transponder Scan:

Select the transponders you want to scan with the **OK** button. The selected transponders will be marked with the ✓ symbol. Press **BLUE** for *Scan*. A window with scan settings will be displayed. After configuring the settings like explained in 7.3.1.2 above, press **OK** or **BLUE** again to start Multi-Scan on all selected transponders.

7.3.1.5 Satellite Edit options

- Add satellites:* Press **RED** to add a new satellite. In the pop-up banner, enter the satellite's name and position by using the ▲/▼ ◀▶ and 0 ~ 9 buttons.
- Satellite Name:* Press **OK** to enter text input mode. In the key table select a character by using the navigation buttons. Press **OK** to enter the chosen character. When you have entered the name, navigate to the "OK" button on screen and press **OK** on the remote control to confirm the new name. Save the settings with **OK** or cancel by ↵.
- Edit satellites:* Press **GREEN** to edit the focused satellite. For changing settings see explanation above. Confirm changes with **OK** or cancel by ↵.
- Delete satellite:* Press **YELLOW** to delete the focused satellite. Press **OK** to confirm deleting or ↵ to cancel.

7.3.1.6 Transponder Edit options

Note: Transponders can only be edited when the transponder list is on screen. To do this, select the satellite you want to edit and press ● to open the TP list. The options below are now available.

- Add transponder:* Press **RED** to add a new transponder. In the pop-up banner, enter the transponder's data by using the ▲/▼ ◀▶ and 0 ~ 9 buttons. Confirm the settings with **OK** or cancel with ↵. An existing TP cannot be stored again under the same satellite.
- Edit transponder:* Press **GREEN** to edit the highlighted transponder. In the pop-up banner, change the transponder's data by using the navigation and numeric buttons. Confirm changes with **OK** or cancel with ↵.
- Delete transponder:* Press **YELLOW** to delete the highlighted transponder. Press **OK** to confirm or ↵ to cancel.

7.3.2 DB Management

This menu allows you to save and reload the channel Data Base of your receiver from/to a USB-device. This very convenient feature enables you to save your personal settings like Channel-, Favourite-, Sat- and TP-lists on an USB storage device and load them back to the receiver later. This feature is especially helpful after unintentional changes or factory reset. In such cases just skip the *First Installation* by pressing ↵ in *Installation guide* and select the *DB management* menu. Connect the USB storage device to you receiver and select one of the options:

7.3.2.1 Load from USB

Press **OK** for displaying the list with available DB files (if any stored before). The DB files „HB_DATABASE_DDMM.DBM“ are shown with their built date (day and month). Select the DB file you want to load and confirm it with **OK**. When the DB has been successfully loaded (message appears on screen) the receiver will switch automatically to the first stored channel and show its content in the background. Press ↵ until the OSD menu disappears.

7.3.2.2 Backup to USB

Press **OK** to make a backup of the data base. A DBM file „HB_DATABASE_DDMM.DBM“ with the current date (day and month), will be created on the USB device. When the DB has been successfully stored a message will be displayed on screen. Press **↵** until the OSD menu disappears.

7.3.2.3 SatCR

If a SatCR LNB is used, please refer to the manual of that LNB to obtain the technical data about User Bands numbers and corresponding frequencies.

Note: SatCR can only work in combination with an optional multi-output (max. 8) satellite splitter and a SatCR LNB, example STRONG type SRT L780 (max. 4 users). **Note:** SatCR cannot be combined with any other DiSEqC function. SatCR systems are mainly installed by professional experts.

<i>SatCR A</i>	Select <i>SatCR A</i> with ▲/▼ and OK , if you only use one SatCR LNB.
<i>SatCR B</i>	When using a two satellite SatCR system, select also the 2nd LNB and setup as described below.
<i>System</i>	Automatic select: Pre-programmed User Bands are installed, refer to the manual of your LNB to know which system is supported by the LNB.
<i>IF Channel</i>	Manual select: Select the User band ID number according to the specifications of your SatCR LNB. Note: Any SatCR LNB user in the chain needs a different Channel ID number.
<i>Center Freq</i>	Manual select: Select the Centre Frequency according to the specifications of your SatCR LNB, corresponding with the correct IF Channel. Note: Any SatCR LNB user in the chain needs a different Centre Frequency.

Press **↵** to store.

7.4 Time and date settings

Press **MENU** and select *Time*. The menu provides options to adjust the time and date settings. Press **▲/▼** to select an option and **◀▶** to adjust the setting. Press **↵** to exit the menu.

Time Offset: Select *Auto* for automatic time and date updates from live signal or *Manual* for entering them manually.

Time Zone: Select the Offset from GMT standard time.

Date: Enter the date when Time Offset is set to *Manual*.

Time: Enter the time when Time Offset is set to *Manual*.

Auto-Standby This feature is implemented for power saving. The receiver will turn to Standby automatically if no command from the remote is received for the selected time period. Default is 3 hours. It can also be turned *Off*.

NOTE: If there are timers running, the auto standby function will be disabled for the booked time.

Timer Enter to the timer (schedule) function. Please refer to section 7.4.2 for details.

Daylight Saving Time Select *On* or *Off* depending on the year's period.

7.4.1 Timer (Schedule)

In this menu you can setup the schedule for automatic switching to the defined channels at a particular date/time. The timer menu can be entered directly from viewing mode by pressing the **BLUE** button.

<i>Add:</i>	Press RED to add a new booking. In the appearing dialog select channel type and number, the starting date and time, end time, repeat cycle (once, daily or weekly). Tip: For selecting the channel number you can use the ◀▶. When you have entered all parameters, press OK to store your booking.
<i>Edit:</i>	Press the GREEN button to edit an existing booking.
<i>Delete:</i>	Press the BLUE button to delete a booking from the list. Press OK to confirm deleting or ⏪ to cancel.

NOTE

You can set timers for programmes directly from the EPG. Please refer to section 6.8 for more details.

7.5 Option

Press **MENU** and select *Option*. In this menu you can adjust the *OSD Language*, *Subtitle Language*, *Audio Language*, *Digital Audio* mode.

Select an option and press ◀▶ to adjust the setting. Press ⏪ to exit the menu.

OSD Language: Select the preferred language for the On Screen Display.

Subtitle Language: Select the preferred subtitle language.

Audio Language: Select the preferred audio language for watching TV channels. If the language is not available, the default programme language will be used
Digital Audio: Select digital audio output mode. Settings affect both S/PDIF and HDMI outputs.

PCM – audio from any format will be converted to PCM format

RAW – audio from receiver will be send in original format

RAW (HDMI On)- As RAW, but also affects the HDMI output.

OFF – digital audio output disabled

7.6 System Settings

Press **MENU** and select *System*. The menu provides options to adjust the system settings.

Press ▲/▼ to select an option and press ◀▶ to adjust the setting. Press ⏪ to exit the menu. Some menu items can only be entered by entering the password. Default is 0000.

Parental guidance Set the age limit for a viewer, if the viewer is underage. This only functions if a broadcaster sends an age-signalling for the current programme.

Set Password

Set or change the password for locked programmes and menu access. Enter your old password or the default password '0000'. You will then be asked to enter your new password. To confirm, re-enter your new password. After confirming, press ⏪ to exit the menu.

Restore Factory Default

Reset your receiver to the default factory settings.

Select *Restore Factory Default* in the main menu and press **OK** or **▶** to select. Enter your password or the default password '0000' and press **OK** to confirm. This option will delete all your channels and settings. The receiver will reboot and start with the *First Installation* menu.

WARNING

A factory reset will permanently delete all your personal settings, timers and stored channels. Please consider this before you perform a factory reset.

Information

Read the technical details of your receiver, like model number, Software/Hardware version and serial number. This information could be asked during a service call or repair request.

Software update

Select *Software Update* in the main menu and press **OK** or **▶** to select.

Download the required update file for your receiver model from the support page on our website www.strong.tv or contact your local dealer. Unzip the file on your computer, if necessary, and copy it to root folder of your USB storage device. Connect the USB storage device to the USB port of the receiver. Press **MENU** and select *Software Update By USB*. Press **OK** to enter the software file list. Select the file containing the software image and press **OK** to initiate the software update. An attention banner will now be displayed. Press **OK** to start the update (or **↵** to cancel it). Follow the instructions displayed on screen. The update process will take some time. After the update process has been completed the receiver will restart and show the last watched channel.

WARNING

NEVER power off the receiver or remove the USB device during the software update process. Doing so might cause irreparable damage to your receiver and will void your warranty.

Banner on screen:

Set the time-out for the info banner. Possible settings are: 3, 5, 7 seconds.

7.7 USB

Press **MENU** and select *USB*. The menu provides the *Multimedia* feature for playback of *Music*, *Photo* and *Movie*. The different file formats listed below are supported. In this menu you can make movie and photo configurations and format the USB device into a format accepted by the receiver. The unit supports USB devices with FAT and FAT32 format. Make sure your USB device is formatted correctly.

NOTE:

- STRONG cannot guarantee compatibility (operation and/or bus power) with all USB mass storage devices and assumes no responsibility for any loss of data that may occur when connected to this unit.
- With large amounts of data, it may take longer for the system to read the contents of a USB device.
- Some USB devices may not be properly recognized. Even when they are in a supported format, some files may not play or display depending on the content.

7.7.1 Multimedia

If there is no USB device plugged in, a warning message "No USB Device is Found" will be displayed. When a USB device is detected you can select between *Music*, *Photo*, *Movie* and *DVR** in this menu. Select one of them, press **OK** to enter the file browser and select the file you want to play.

Music – supported file formats are MP3 and WMA**

Photo – supported file formats are JPG and BMP**

Movie – supported video files in various formats (MPG, MPEG, TS, VOB, MP4, AVI, ...)**

*DVR** – your recordings made by this unit. Find the HBDVR folder or use shortcut with the **▶** button.

*This user manual describes the full functionality including the recording function and may not be applicable if the software for recording via USB has not yet been installed.

**STRONG cannot guarantee the playback of video files although extensions are listed here, as the correct playback depends on codec used, data bit rate and resolution as well. Please consult the STRONG Hotline in your country to get more details.

Music

Select a music file and press **OK** to start playback.

During playback, following functions are available:

- ▶** or **OK**: Start playback of the selected file.
- II**: To pause/resume playback and **■** to stop it.
- ◀▶**: To rewind or forward playback in x2, x4, x8, x16 and x32 speed. When it has fast rewound to the beginning, playback of the current file will be resumed. When it has fast forwarded to the end, playback of the next file starts.
- BLUE**: Opens a counter banner for entering the time moment you want to jump to. Use the **0~9** buttons for entering the time and **OK** to confirm.
- ◀▶▶**: Start playback of the previous/next file.
- ⌂**: Goes to the parent folder.
- ⏪**: To get back to the *Multimedia* menu. Press **⏪** once more if you want to leave the *Multimedia* menu.

TIP

Playback of music will continue as long as the *Multimedia* menu is active. This allows you to listen to music while watching photos. Just exit the *Music* submenu and select a slide mode in the *Photo* submenu like explained below.

Photo

Your receiver allows you to watch a slide show with all available photos in the chosen folder. Choose a folder with photo files for the slide show. Press **▶** to start the slide show and **■** or **⏪** to stop. See the different *Photo Configure* options explained in point 7.7.2 below.

In the *Photo* mode following functions are available:

- OK**: Opens a selected photo in full screen format
- ▶**: Starts the slide show
- II**: To pause/resume slide show.
- or **⏪**: To close the full screen format or to stop the slide show and return to the folder view.
- INFO**: To open/close the photo details banner in the full screen or slide show mode.

RED	To zoom a photo (use ▲/▼ ◀▶ to navigate to a certain part of the zoomed picture).
GREEN	To turn the photo counter clockwise.
YELLOW	To turn the photo clockwise.
BLUE	Opens a grid view (to go back press ⏪)
⏪	Goes to the parent folder.
⏩	Open the previous/next photo.
⏪	To get back to the <i>Multimedia</i> menu. Press ⏪ again if you want to leave the <i>Multimedia</i> menu.

Movie

In the *Movie* menu you have to navigate to a movie file.

Select the file and press **OK** to start playback in preview mode. Use the **RED** button to switch between preview and full screen. Use **⏪** to go to the parent folder.

During playback you can use the playback control buttons, such as **II**, **▶**, **■**, **◀▶**, **⏪** and **⏩**. You can check the file details by pressing the **INFO** button in full screen mode. To close the banner, press **INFO** again or **⏪**. Use the **BLUE** button and enter the time moment you want to jump to with the **0-9** buttons, then press **OK** to confirm. With the **◀▶** buttons you can rewind or forward playback in x2, x4, x8, x16 and x32 speed. When it has fast rewound to the beginning, playback of the current file will be resumed. When it has fast forwarded to the end, playback of the next file starts. With the **⏪** buttons you can jump to the previous/next video file.

7.7.2 Photo Configure

<i>Slide Time:</i>	You can adjust the slide show interval to 1~8 seconds.
<i>Slide Mode:</i>	You can select one of the 60 slide show effects or <i>Random</i> (mixed effects).
<i>Aspect Ratio:</i>	Keep - displays the picture as its original aspect Discard - displays the picture in full screen mode.

7.7.3 Movie configure

This subtitle function is only relevant in the *Movie* menu for movies which contain subtitle files in .srt or txt format.

During playback, press **SUB** to select a language and confirm with **OK**. During playback of *Movie* files you can press **SUB** twice to change the subtitle settings described below:

<i>Subtitle Specific:</i>	Choose subtitle size between <i>Small</i> , <i>Normal</i> and <i>Big</i> .
<i>Subtitle BG:</i>	Choose subtitle background between <i>White</i> , <i>Transparent</i> , <i>Gray</i> and <i>Yellow-Green</i> .
<i>Subtitle FontColour:</i>	Choose subtitle font colour between <i>Red</i> , <i>Blue</i> , <i>Green</i> , <i>White</i> and <i>Black</i> .

7.7.4 DVR, Timeshift and Format*

*This user manual describes the full functionality including the recording function and may not be applicable if the software for recording via USB has not yet been installed.

7.7.4.1 Instant recording*

To directly record a programme, press the **●** button to start the recording and press **■** to quit. During a recording it is possible to press the **▲/▼** buttons or the **OK** and **▲/▼** buttons to change to another channel on the same transponder only. It is not possible to use the **0-9** buttons.

7.7.4.2 Timeshift*

If you want to use the Timeshift function you only need to press **||** in viewing mode. To playback timeshifted content, press **▶** or **||** again. During playback you can use the **◀▶** or **||** buttons. To quit the Timeshift mode, press **■**. If you haven't pressed **■** the Timeshift mode will be kept in the background. If the channel is changed timeshifted content will only be accessible from the new selected channel.

7.7.4.3 Timer recording

There are 2 ways to set a timer:

Programming a timer via the EPG

The easiest way to record an event is via the EPG. Press the **EPG** button to open the EPG, then **◀** to select a channel. After that, press **▲/▼** to select an event. You can book a timer by pressing the **OK** button. The event data will be applied and you only need to press the **▲/▼** buttons to select *Mode* and **◀** to *Record*. If needed, the parameters for the timer can be changed as well. Press **▲/▼**, **◀** and use **0-9** to do so. From the EPG channel list view you can open the *Book list* with the **INFO** button, which allows you to open a list of all booked timers.

Programming a timer via the Timer menu

If you want to programme a timer via the timer menu, press the **BLUE** button to open it. Now the timer list is displayed. The list is empty if no bookings have been made previously. Press **RED** to *Add* a new timer and configure your timer as explained above. For further details about this menu, please refer to chapter **7.4.1 Timer (Schedule)** in the user manual.

7.7.4.4 Playback

After a recording has been made you will find the new folder *HBDVR* created on your external USB storage device. By pressing the **▶** button in viewing mode you can access this folder directly. Inside the folder *HBDVR* the following functions are supported:

- | | |
|---------------|---|
| OK | Starts playback in preview mode. |
| RED | Starts playback in full screen mode. |
| ⏪ | Accesses the parent folder/directory. |
| YELLOW | Marks a recording for deletion. When all recordings you want to delete are marked, press OK . A message will appear to confirm deleting. By pressing OK again the recordings will be permanently deleted from your external USB storage device. Press ⏪ if you don't want to delete them. |
| GREEN | Opens the keyboard for entering a new name for a selected recording. In the keyboard, press ▲/▼ ◀▶ for navigation, to enter a character press OK . After finishing your changes, select <i>OK</i> and press the OK button to save the new name. If you want to discard your changes select <i>Cancel</i> and then press OK . |

BLUE Allows you to enter the time to start playback. To enter the desired time use **0-9** and press **OK** to start the playback at this time.

*This user manual describes the full functionality including the recording function and may not be applicable if the software for recording via USB has not yet been installed.

7.7.4.5 DVR Configure*

Find technical details about your USB device, like *Partitions*, *Timeshiftsize*, *Total space* and *Free space*.

7.7.4.6 Format*

WARNING The format function will delete all data and information from your USB device or selected partition. STRONG will not take any responsibility for damaged or lost data on the USB device.

If you have multiple partitions on your storage device, select the partition you would like to format and press **OK** to continue. An attention banner will now be displayed. Press **OK** to start formatting (or **ESC** to cancel it). The format procedure will take some time, depending on the size of the used storage device. At the end of the process, the "Formatting is complete" message will appear. Press **ESC** to exit the menu.

8.0 TROUBLESHOOTING

There may be various reasons for abnormal operation of the receiver. Please check the receiver according to the procedures shown below. If the receiver does not work properly after checking it, please contact your local Service line or STRONG dealer. Alternatively, you can send a support mail via our website: www.strong.tv. NEVER open or disassemble your receiver. This may cause a dangerous situation and will void the warranty.

PROBLEM	POSSIBLE CAUSE	WHAT TO DO
The standby indicator does not light up	The mains lead is unplugged/ the multipoint connector is switched off.	Check the mains lead/switch the multipoint connector on.
No picture	The receiver can't receive signal.	Check the antenna cable, replace the cable, or connect the cable to the receiver tightly.
	Incorrect values of some tuner parameters.	Set the values of tuner parameters correctly in the <i>Installation</i> menu.
	Wrong direction of the dish.	Check signal strength and adjust your dish correctly.

No picture or sound on TV	The input is not selected on your TV.	Switch to the correct TV input.
	The TV is not connected to the mains. Bad cable connection.	Check the mains lead. Firmly plug in the cables between the receiver and TV.
	Audio muting.	Press the  button.
	TV power off.	Turn the TV on.
Scrambled channel message	The channel is scrambled.	Select an alternative channel.
No response to remote control	The receiver is off.	Plug in and turn on the plug.
	The handset is not aimed correctly.	Aim the handset at the IR sensor.
	The IR sensor is obstructed.	Check for obstructions.
	The handset batteries are exhausted.	Replace the handset batteries.
Password forgotten	The default password is 0000	Contact the local Service Hotline or send an email to our support via www.strong.tv
The external USB HDD does not start.	The power consumption is too high.	Connect an extra power supply adapter to your USB HDD device.
The receiver switches to standby automatically.	The <i>Auto Standby</i> function is activated and has reached the set time (default 3h).	Set the power down time or disable it in the <i>System Auto Standby</i> menu .

9.0 SPECIFICATIONS

Demodulator

Demodulation:	QPSK, 8PSK
Input symbol rate:	DVB-S QPSK: 1 ~ 45 Ms/s DVB-S2 8PSK/QPSK: 10~30 Ms/s
FEC decoder:	Auto, 1/2, 2/3, 3/4, 5/6, 7/8 in DVB-S mode 1/2, 3/5, 2/3, 3/4, 4/5, 5/6, 8/9, 9/10 in DVB-S2 mode 3/5, 2/3, 3/4, 5/6, 8/9, 9/10 in 8PSK mode

Video Decoder

Input rate:	Max. 20 Mbit/s
Aspect ratio:	16:9 widescreen, Pillarbox, 4:3 Pan&Scan, Letterbox
Video resolution:	PAL 50Hz: 576i, 576p, 720p, 1080i, 1080p NTSC 60Hz: 480i, 480p, 720p, 1080i, 1080p

Audio Decoder

Audio decoding:	MPEG-1 Layer 1 & 2, AC3, Dolby Digital Down mix, PCM
Audio mode:	Mono L/R, Stereo
Audio Support:	E-AC3, Dolby Digital, Dolby Digital Plus*
Sampling rate:	32, 44.1, 48 kHz

*Dolby Digital Plus, Dolby Digital and the double-D symbol are registered trademarks of Dolby Laboratories

Tuner

Type1:	F Type, IEC169-24, Female
Input frequency range:	950 – 2150 MHz
RF impedance:	75 Ohm unbalanced
Signal level:	-65 to -25 dBm
LNB power:	13/18 V DC (+/- 5%), max. 0.5 A, overload protected
Switch versions:	DiSEqC 1.0, 1.1
LNB options:	Universal, SatCR (max. 8 users)
Motor drive options:	DiSEqC 1.2, GotoX (DiSEqC 1.3)

System & Memory

Main processor:	MSTAR MSD7S01
Flash memory:	4 MB
System memory:	64 MB

Multimedia

Video playback:	Supported in various formats (MPG, MPEG, VOB, MP4, AVI...)*
Audio playback:	MP3, Flac*
Picture view:	JPG, BMP*

*STRONG cannot guarantee the playback of files although extensions are listed, as it depends on codec used, data bit rate and resolution (all MPEG codec formats are supported).

Connectors

SAT IN

USB 2.0 port: 5 V/800 mA (max.) supported

HDMI

TV SCART (RGB, CVBS, Audio L/R)

3.5 mm Audio L/R

S/PDIF (coax.)

Power adapter (12 V, 1.5 A)

General Data

Power supply:	AC 100 – 240 V ~ 50/60 Hz
Input voltage:	DC 12 V 1.5 A
Power consumption:	max. 18 W, typ. 5 W
Power consumption in standby:	max. 0.5 W
Operating temperature:	0 ~ +40 °C
Storage temperature:	-10 ~ +50 °C
Operating humidity range:	10 ~ 85% RH, Non-condensing
Size (W x D x H) in mm:	170 x 122 x 40
Weight in kg:	0.30

STRONG declares that this item complies with the basic requirements and other relevant regulations of directives CE 2004/108/EC and 73/23/EC, RoHS 2002/95/EC

Subject to alterations. In consequence of continuous research and development technical specifications, design and appearance of products may change. Manufactured under license from Dolby Laboratories. Dolby Audio, Dolby Digital, Dolby and the double-D symbol are trademarks of Dolby Laboratories. HDMI, the HDMI logo and High-Definition Multimedia Interface are trademarks or registered trademarks of HDMI Licensing LLC in the United States and other countries. All product names are trademarks or registered trademarks of their respective owners.

© STRONG 2022. All rights reserved.